



Defiant-X //

OPERATION INSTRUCTIONS

For your safety, it is important that you completely read the instructions and warnings.



Defiant-X

CONTENTS

TO OPEN/CLOSE SHIELD	3
TO OPERATE DEMIST SYSTEM	4
TO OPERATE BROWVENTS	4
TO OPERATE MOUTHVENT	5
TO OPERATE TOP VENTS	5
TO REMOVE/REPLACE SHIELD	5
TO REMOVE/REPLACE BASE PLATE	6
TO REMOVE/REPLACE TETHER	7
TO REMOVE/REPLACE CHEEKPADS	7
TO REMOVE/REPLACE COMFORT LINING	9

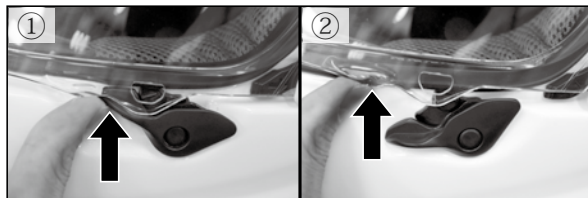

TO OPEN/CLOSE SHIELD

To open, push the shield latch lever up and the shield will open slightly ①. Then pull the bulge on the shield slightly outward so the shield clears the latch post on the helmet ②, and raise the shield.

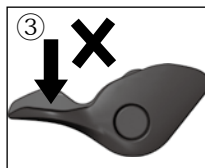

WARNING : Do not attempt to open the shield without using the latch system, or push down on the shield latch lever ③, as damage to the latch system may occur.

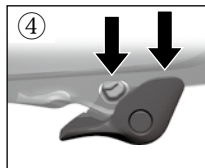

To close, push the shield down until the latch post fully engages the shield and the latch lever captures the bottom of the shield ④.

WARNING : Be sure to latch the shield properly before riding. If not latched securely, the shield may open unexpectedly from wind pressure, vibration or even normal head movement.

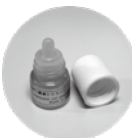
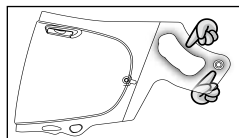

If shield operation becomes stiff, flexing excessively as you raise or lower it, apply one or two drops of supplied silicone lubricant around sliding slot and brass stud, and wipe off with soft tissue paper for shield operation maintenance. If shield is dirty, clean before applying silicone.

WARNING :

If your shield becomes too scratched or uncleanable, replace it with a new one. Impaired visibility causes accidents.

Use a solution of mild soap or detergent and lukewarm water to clean your shield. Rinse well with clean water, and wipe off with a soft cloth. Never use petrol, thinner, benzene or any other solvents. There are many "aggressive" cleaners on the market, including some supposed to be specifically for use on shield. Arai strongly recommends that you do not use any such products to clean your shield as some of their ingredients may have damaging effects on the shield and other plastic parts installed on your helmet.

Do not apply stickers or adhesive tape to the shield, as this will weaken the hard coating. If tinted, the shield is for daylight use only.

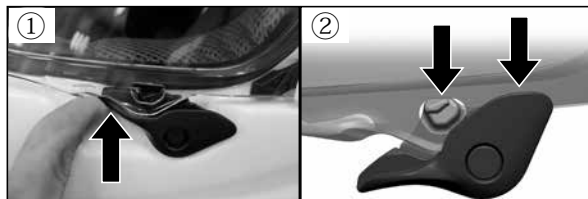

TO OPERATE DEMIST SYSTEM

A demist function is incorporated in the shield latch system to allow more rapid clearing of any interior mist with the shield remaining partially latched. Push the shield latch lever up to release shield into the demist position to assist moisture dispersal ①. To close the shield completely, push the shield down until the latch post fully engages the shield and latch lever captures the bottom of the shield ②.

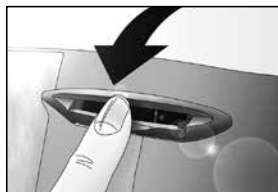

TO OPERATE BROWVENTS

The Browvents are operated from fully closed through intermediate, to fully open positions by simply pulling the vent control down to open, pushing up to close.

English

TO OPERATE MOUTHVENT

To open, slide the tab on each side outward. To close, slide each tab as shown.

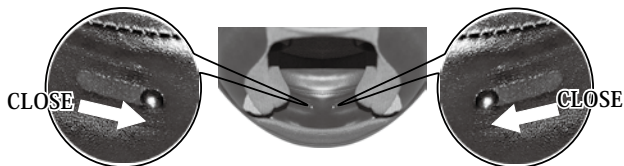

TO OPERATE TOP VENTS

Simply push the switches/levers on each vent to open/close the vents.

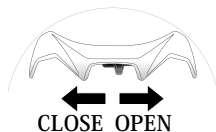

NOTE : Do not use oils or waxes to lubricate vents or other moving parts. If you must lubricate such components, sparingly use the silicone lubricant supplied with your helmet for eyeport trim dressing.

TO REMOVE/REPLACE SHIELD

To remove, place shield in the fully open position ①. Push the side pod release lever from the front edge of the side pod backward ② to release the side pod ③.

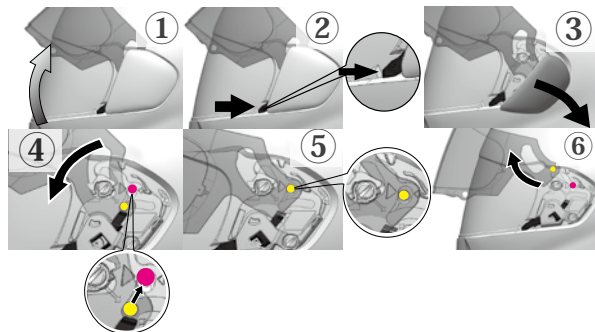

Then lower the shield until the brass stud of the shield moves into the red hole of the base plate ④. Remove the shield from the spring clips ⑤ & ⑥, and repeat for the other side.

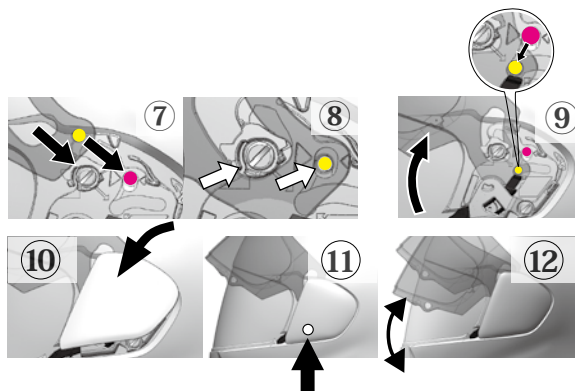

To replace, position the shield on the base plate so that the lower part of the sliding slot of the shield is over the spring clip of the base plate and the brass stud is in the red hole of the base plate ⑦. Press the shield onto the spring clip, and then fully raise the shield until the brass stud falls into the sliding slot of the base plate ⑧ & ⑨. Position top hook on the backside of the side pod into the top tab of base plate ⑩, align the side pod with the recess of the helmet shell and push the lower part of the side pod down firmly until it clicks into place and is fully captured by the base plate ⑪. Repeat for the other side. Work the shield up and down to confirm proper operation ⑫.

TO REMOVE/REPLACE BASE PLATE

To remove, first remove the shield. Remove two screws from each base plate with a flat blade screwdriver or a coin ①. Remove plates from helmet shell. Note the right and left base plate for proper reinstallation.

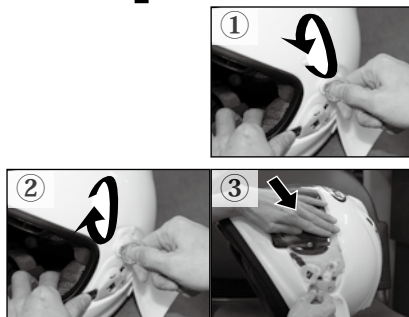

To replace, place base plate over the threaded screw receptacles in the helmet. Install the two screws through each base plate into the helmet finger tight ②, do not fully tighten. Install shield, lower the shield to fully closed position and press the front center of the shield to bring it against the eyepoint trim. While still pushing on the shield to keep a tight seal against the eyepoint trim, tighten the base plate screws ③ – but be careful not to overtighten, as the screws may break. It may be necessary to do one side at a time, with a smoothing pressure from the shield center toward each base plate and tightening one and then the other for best results.

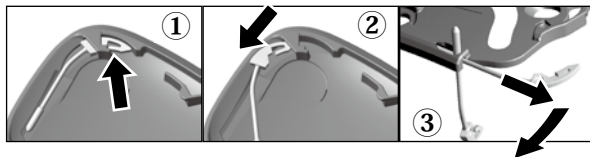

TO REMOVE/REPLACE TETHER

To remove the tether connecting the side pod and base plate, compress the tether spring hook at the side pod ① and pull the tether out from the slot ②.

To remove tether from the base plate, remove base plate from helmet. Pull tether until it stops, then bend it toward the back of the base plate to release it ③. To reinstall, reverse the removal procedure.

TO REMOVE/REPLACE CHEEKPADS

When first servicing the cheekpads, it is suggested that you do only one at a time so that the other can be used as a reinstallation guide.

To remove the cheekpads, first undo chinstrap.

Lift up the neckroll tab, which is inserted under the black covering at the forward lower edge of the pad assembly.

Pull the pad toward the front of the helmet, then inward to release and slide it off the strap.

To take off the fabric covering for washing, peel the covering off over the rear edge of the cheekpad assembly until all the fabric is on the face side surface. Then draw the covering through the opening by grasping the rectangular collar and pulling.

To wash fabric coverings, put them into lukewarm water with small amount of laundry soap or your own shampoo and wash gently by hand. Rinse well with fresh water and wipe off with a soft cloth. Dry them in the shade at ambient temperature.

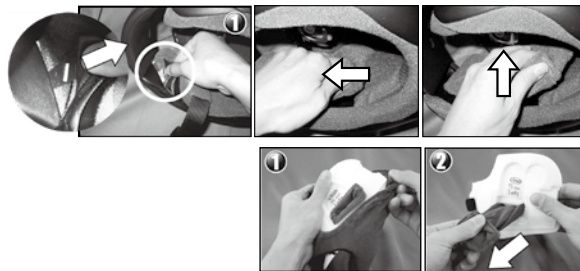

WARNING :

Never use petrol, thinner, benzene or any other solvents.

To replace the fabric covering, ensure it is turned right side out, and stretch the covering over the pad, and adjust the covering to lie smoothly. Then push the rectangular collar through the pad assembly and adjust into final position.

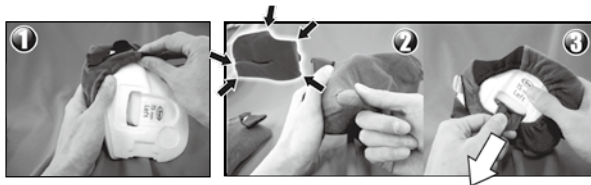

To replace a cheekpad in helmet, slip pad onto strap.

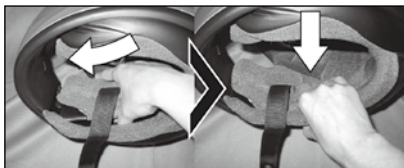

Place the front tab toward the front of the helmet and push the rear part of pad until the pad is fully home.



Replace the neckroll tab into place.

Pull the chinstrap to check possible chinstrap play in the cheekpad.

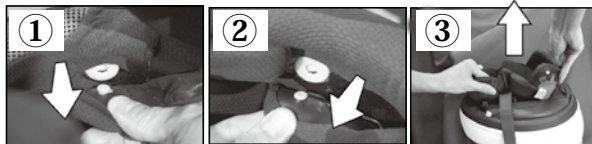

TO REMOVE/REPLACE COMFORT LINING

The comfort lining is secured to the helmet by plastic bosses ①.

To remove the lining, undo bosses by grasping the lining as close to each boss as possible ② and pulling straight up ③. Note the fore & back, top & bottom sides of the lining for replacement.

To wash the comfort lining, put it into lukewarm water with small amount of laundry soap or your own shampoo and wash gently by hand. Rinse well with fresh water and wipe off with a soft cloth. Dry it in the shade at ambient temperature.

WARNING : Never use petrol, thinner, benzene or any other solvents.



To replace the lining, place the bosses over their plastic receptacles and push them home ④, ⑤ & ⑥.

WARNING : When reinstalling the comfort lining, be sure the lining is properly positioned along the inside shape of the EPS (a.k.a. Styrofoam) liner. If the comfort lining is not properly installed, the frame of the comfort lining may fold when you put on and take off the helmet, which may injure your skin, etc. Whenever you feel something is wrong with the comfort lining, check that the lining is properly installed.



there is a difference



there is a difference

Helmet Specifications Subject to Change Without Notice.

Contact to :

ARAI HELMET, LIMITED

12 Azuma-cho, 2-chome
Omiya, Saitama
Japan 330-0841

ARAI HELMET (AMERICAS), INC.

P.O. Box 787
Fogelsville, PA 18051-0787
U.S.A.